

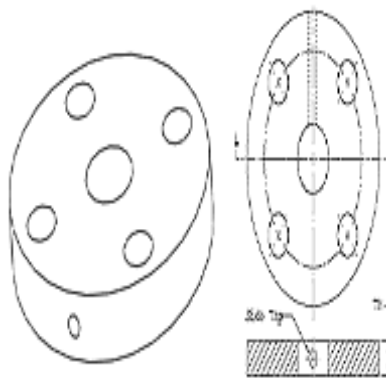

## Orifice Flanges

Orifice Flanges are used instead of the normal pipe flanges when orifice plate or flow nozzle is applied. In other words, orifice flanges are utilized having orifice metres. The basic function just for this is to test this stream rate involving often gas or maybe beverages inside the respective pipeline. These flanges are utilized as a part of different modern applications and are accessible in different sizes and materials. All opening flange units are furnished with the plate, pressure association holes, and jack screws.



### Key Features of Orifice Flanges:

Come with either raised confronts or ring sort joint (RTJ) facings.

The orifice flanges have adjustments of radial tapped holes in the flange ring for meter associations.

There are the orifice plate transporters in these flanges for the reason of fitting meter associations.

The extra bolts accessible serve as a jack to allow the division of the two flanges to change the orifice plate or for other applicable administrations like assessment.

### Uses of orifice flanges:

The fundamental cause for an orifice flange is utilized to flow/rate metering of piping systems.

They are used for all escalated purposes, like weld neck and slip-on flanges with additional machining.

### Orifice flanges Product Range

#### Orifice Flanges Range

½" (15 NB) to 48" (1200NB) in 150 LBS, 300 LBS, 600 LBS, 900 LBS, 1500 LBS, 2500 LBS ASA 150, ASA 300, PN 6,10,16,25, 40,64,100,160 ETC. Available with NACE MR 01-75

#### Stainless Steel Orifice Flanges

Grade : 304, 304L, 304H, 309, 310, 310S, 316, 316Ti, 316 L, 317, 317L, 321, 347, 347 H, 409, 410, 410S, 420, 430L

|                |   |  |
|----------------|---|--|
| Address        | : | <b>Rexino Stainless &amp; Alloys,</b><br>Shop No. 6, Ghojaria Estate no. 2<br>Kharwa Lane, 6th Kumbharwada<br>Kumbharwada<br>Mumbai- 400004            |
| E-mail         | : | <a href="mailto:info@rexinostainless.com">info@rexinostainless.com</a> ,<br><a href="mailto:export@rexinostainless.com">export@rexinostainless.com</a> |
| Visit Us       | : | <a href="http://www.rexinostainless.com">www.rexinostainless.com</a>   |
| Contact Person | : | <b>Mr. Bhavesh Chandan</b>   |
| Mobile         | : | <b>+91- 9920773453</b>   |



### **Duplex Steel Orifice Flanges**

Grade : 2205 (UNS No. S31803), 2507 (UNS No. S32750)

### **Nickel Alloy Orifice Flanges**

Grade : Nickel 200 (UNS No. N02200), Nickel 201 (UNS No. N02201), Monel 400 (UNS No. N04400), Monel 500 (UNS No. N05500), Inconel 800 (UNS No. N08800), Inconel 825 (UNS No. N08825), Inconel 600 (UNS No. N06600), Inconel 625 (UNS No. N06625), Inconel 601 (UNS No. N06601), Hastelloy C 276 (UNS No. N10276), Alloy 20 (UNS No. N08020), Titanium (Grade I & II)

### **Copper Alloy Orifice Flanges**

Grade : UNS No. C 10100, 10200, 10300, 10800, 12000, 12200, 70600, 71500, UNS No. C 70600 (Cu -Ni- 90/10), C 71500 (Cu -Ni- 70/30)

### **Orifice Flanges Standard**

ANSI : ANSI B16.5, ANSI B16.47, MSS SP44, ANSI B16.36, ANSI B16.48

DIN : DIN2527, DIN2566, DIN2573, DIN2576, DIN2641, DIN2642, DIN2655, DIN2656, DIN2627, DIN2628, DIN2629, DIN 2631, DIN2632, DIN2633, DIN2634, DIN2635, DIN2636, DIN2637, DIN2638, DIN2673

B.S : BS4504 , BS4504, BS1560, BS10

OTHER : PLATE, PLATE BLANK

### **Value Added Services for Orifice Flanges**

HOT DIPPED GALVANIZING

HEAT TREATMENT

CNC MACHINING

THREADING

|                       |   |   |
|-----------------------|---|---|
| <b>Address</b>        | : | <b>Rexino Stainless &amp; Alloys,</b><br>Shop No. 6, Ghojaria Estate no. 2<br>Kharwa Lane, 6th Kumbharwada<br>Kumbharwada<br>Mumbai- 400004 |
| <b>E-mail</b>         | : | <b>info@rexinostainless.com ,</b><br><b>export@rexinostainless.com</b>  |
| <b>Visit Us</b>       | : | <b>www.rexinostainless.com</b>  |
| <b>Contact Person</b> | : | <b>Mr. Bhavesh Chandan</b>  |
| <b>Mobile</b>         | : | <b>+91- 9920773453</b>  |



# REXINO

## STAINLESS & ALLOYS



### Technical Specification

### 900 LB.FLANGES

| Normal pipe size | Outside dia. of flange | Minimum thickness of flange | Overall Length |                          |           | Bolt Circle | No. and Size of Holes |      | O.D. of raised face |
|------------------|------------------------|-----------------------------|----------------|--------------------------|-----------|-------------|-----------------------|------|---------------------|
|                  |                        |                             | Welding neck   | Slip-on & socket welding | Lap Joint |             | No.                   | dia. |                     |
|                  | O                      | Q                           | Y              |                          |           | Diam.       |                       | R    |                     |
| 1/2              | 121                    | 22.4                        | 60.5           | 31.8                     | 31.8      | 82.6        | 4                     | 22.4 | 35.1                |
| 3/4              | 130                    | 25.4                        | 69.9           | 35.1                     | 35.1      | 88.9        | 4                     | 22.4 | 42.9                |
| 1                | 149                    | 28.4                        | 73.2           | 41.1                     | 41.1      | 101.6       | 4                     | 25.4 | 50.8                |
| 1-1/4            | 159                    | 28.4                        | 73.2           | 41.1                     | 41.1      | 111.3       | 4                     | 25.4 | 63.5                |
| 1-1/2            | 178                    | 31.8                        | 82.6           | 44.5                     | 44.5      | 124.0       | 4                     | 28.4 | 73.2                |
| 2                | 216                    | 38.1                        | 101.6          | 57.2                     | 57.2      | 165.1       | 8                     | 25.4 | 91.9                |
| 2-1/2            | 244                    | 41.1                        | 104.8          | 63.5                     | 63.5      | 190.5       | 8                     | 28.4 | 104.6               |
| 3                | 241                    | 38.1                        | 101.6          | 53.8                     | 53.8      | 190.5       | 8                     | 25.4 | 127                 |
| 4                | 292                    | 44.5                        | 114.3          | 69.9                     | 69.9      | 235.0       | 8                     | 31.8 | 157.2               |
| 5                | 349                    | 50.8                        | 127.0          | 79.2                     | 79.2      | 279.4       | 8                     | 35.1 | 185.7               |
| 6                | 381                    | 55.6                        | 139.7          | 85.9                     | 85.9      | 317.5       | 12                    | 31.8 | 215.9               |
| 8                | 470                    | 63.5                        | 162.1          | 101.6                    | 114.3     | 393.7       | 12                    | 38.1 | 269.7               |
| 10               | 546                    | 69.9                        | 184.2          | 108.0                    | 127.0     | 469.9       | 16                    | 38.1 | 323.9               |
| 12               | 610                    | 79.2                        | 200.2          | 117.3                    | 142.7     | 533.4       | 20                    | 38.1 | 381                 |
| 14               | 641                    | 85.9                        | 212.9          | 130.3                    | 155.4     | 558.8       | 20                    | 41.1 | 412.8               |
| 16               | 705                    | 88.9                        | 215.9          | 133.4                    | 165.1     | 616         | 20                    | 44.5 | 469.9               |
| 18               | 787                    | 101.6                       | 228.6          | 152.4                    | 190.5     | 685.8       | 20                    | 50.8 | 533.4               |
| 20               | 857                    | 108                         | 247.7          | 158.8                    | 209.6     | 749.3       | 20                    | 53.8 | 584.2               |
| 24               | 1041                   | 139.7                       | 292.1          | 203.2                    | 266.7     | 901.7       | 20                    | 66.5 | 692.2               |

**Address** : Rexino Stainless & Alloys,  
 Shop No. 6, Ghojaria Estate no. 2  
 Kharwa Lane, 6th Kumbharwada  
 Kumbharwada  
 Mumbai- 400004

**E-mail** : [info@rexinostainless.com](mailto:info@rexinostainless.com) ,  
[export@rexinostainless.com](mailto:export@rexinostainless.com)

**Visit Us** : [www.rexinostainless.com](http://www.rexinostainless.com)

**Contact Person** : **Mr. Bhavesh Chandan**

**Mobile** : **+91- 9920773453**



|                       |   |   |
|-----------------------|---|---|
| <b>Address</b>        | : | <b>Rexino Stainless &amp; Alloys,</b><br>Shop No. 6, Ghojaria Estate no. 2<br>Kharwa Lane, 6th Kumbharwada<br>Kumbharwada<br>Mumbai- 400004 |
| <b>E-mail</b>         | : | <b>info@rexinostainless.com ,</b><br><b>export@rexinostainless.com</b>  |
| <b>Visit Us</b>       | : | <b>www.rexinostainless.com</b>  |
| <b>Contact Person</b> | : | <b>Mr. Bhavesh Chandan</b>  |
| <b>Mobile</b>         | : | <b>+91- 9920773453</b>  |